

NOTE:
 ONLY WHEN WATER MAIN IS LOCATED TOO CLOSE TO THE R/W TO KEEP THE FIRE HYDRANT INSIDE THE R/W THEN THE FIRE HYDRANT SHOULD BE LOCATED ON THE PROPERTY LINE OR AN EASEMENT SHOULD BE OBTAINED

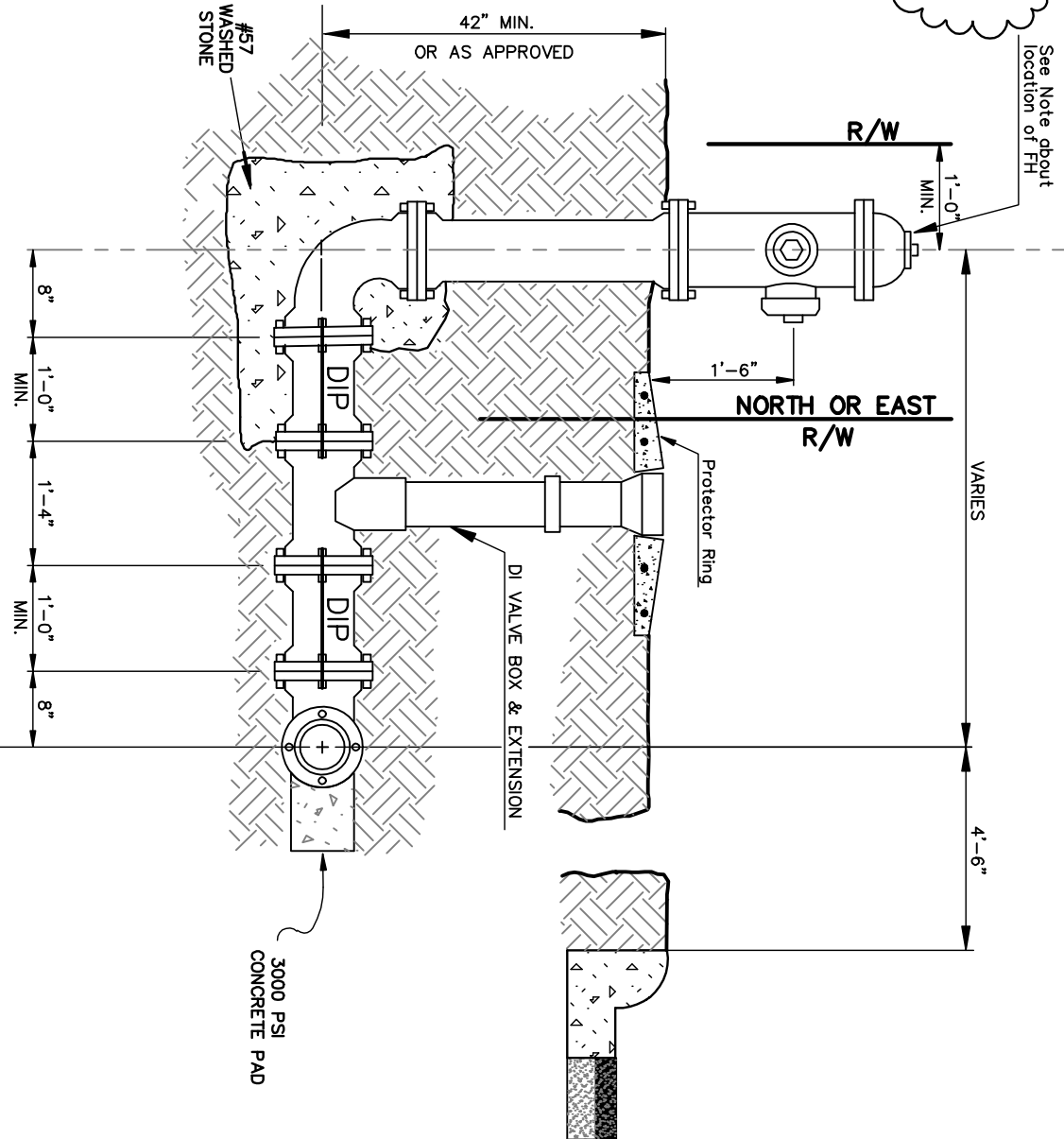
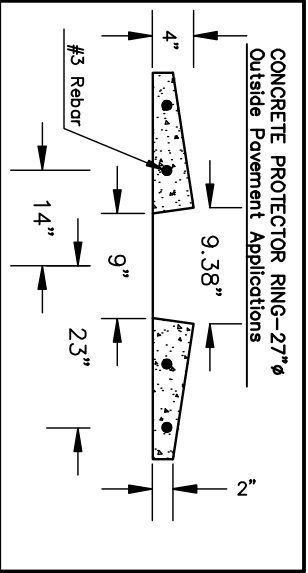
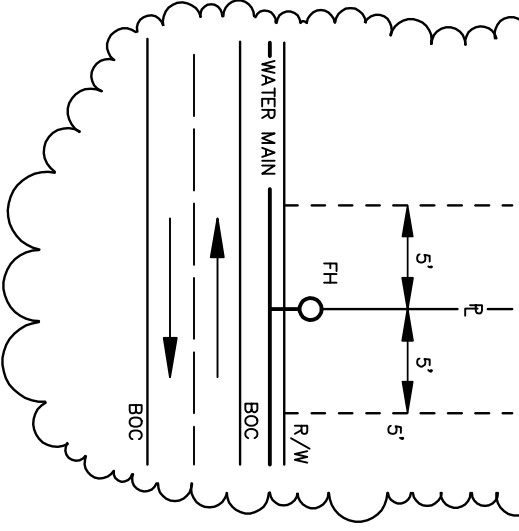

Standard Detail

**Standard Fire Hydrant Installation
 Within Utility Easement**

REVISED F.B. PG. DATE: 3-19-74

12-6-84 SCALE: FULL

5-29-97 DRAWN BY: RMN

2-02-01 CHECKED BY: NBM, FAP

2-08-05 CITY ENGINEER: JPB

OFFICE OF THE
 CITY ENGINEER
 GASTONIA, N.C.

FILE NO. **71B-7**